



Lewis M. Milrod, M.D., P.C.

Pediatric Neurology and Sleep Medicine

80 Lincoln Highway (State Route 27)  
Rear Suite  
Edison, NJ 08820

Phone: 732-548-BRAIN (2724)

Fax: 732-623-9721

## HOW MEDSENDER CAN WORK FOR YOU!

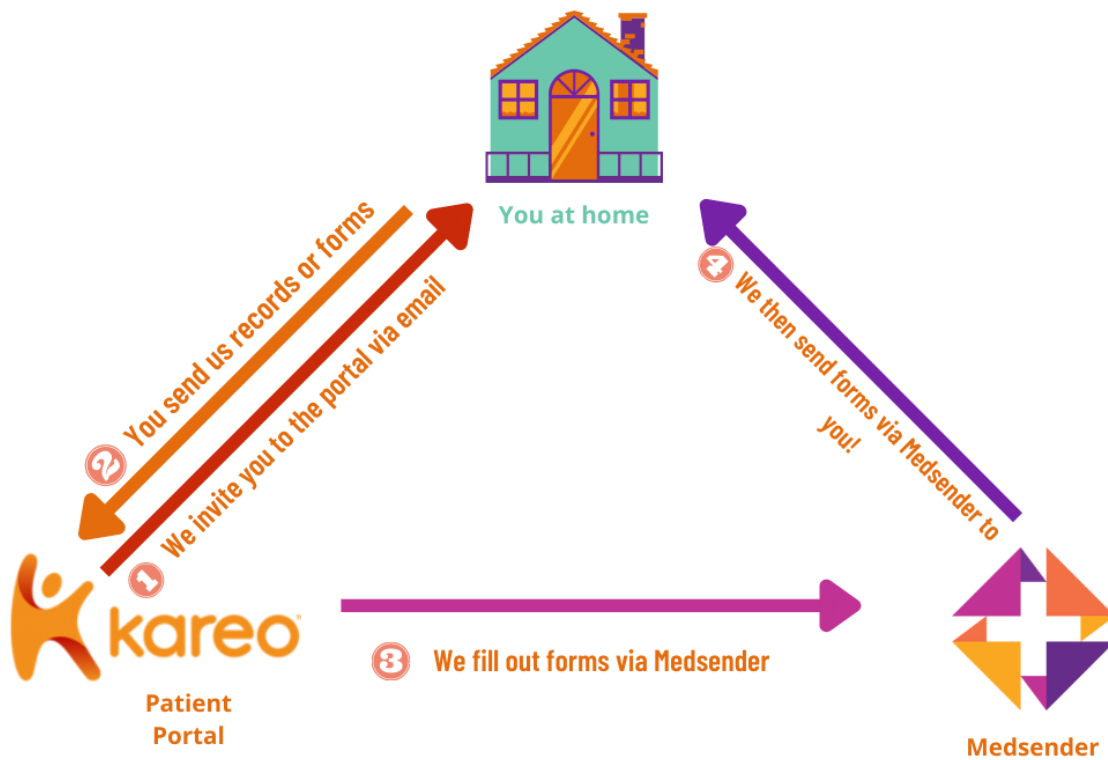

### Instructions:

Documents are available on Medsender for 30-60 days only. It is recommended that you download the document for your records. You may download or print the record from the toolbar as shown below:

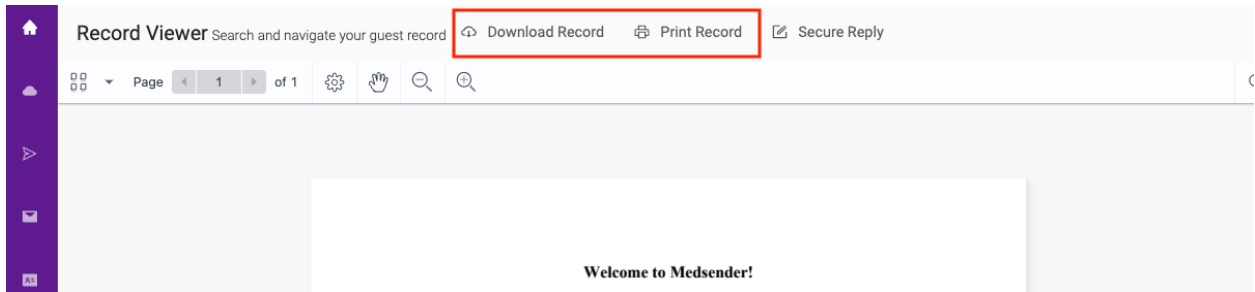

You may also reply once to the record by clicking on the Secure Reply link found above.

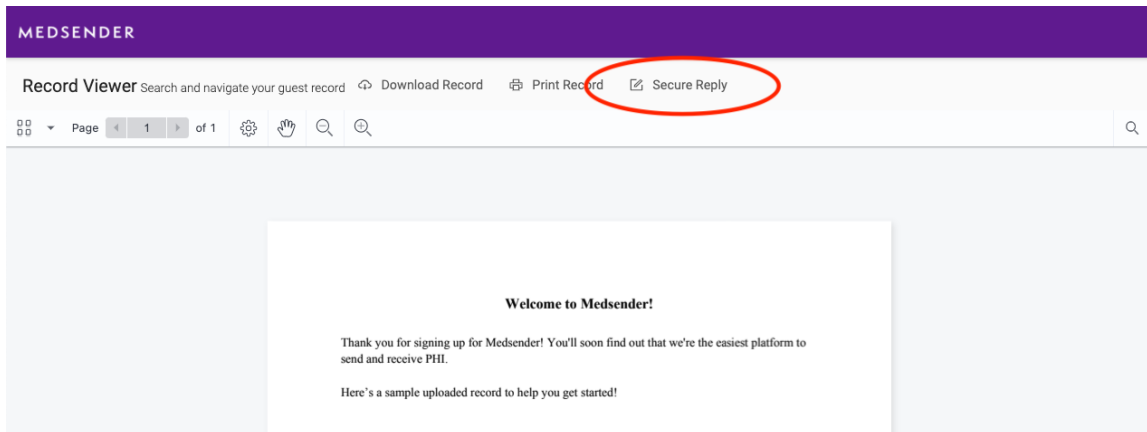

Once you click “Secure Reply,” please enter your message in the “body” field and your contact information in the bottom section as shown below. You may also include attachments, such as a photo of your insurance card, by clicking the purple “Attach document(s)” button.

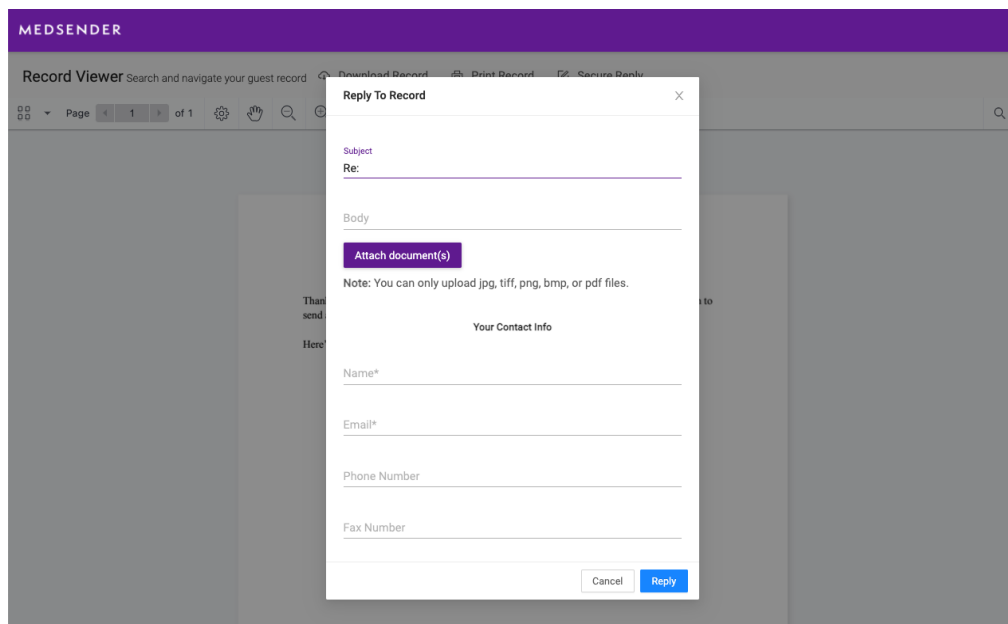

If the document requires your signature, you can click the “Sign Document” button and draw your signature.

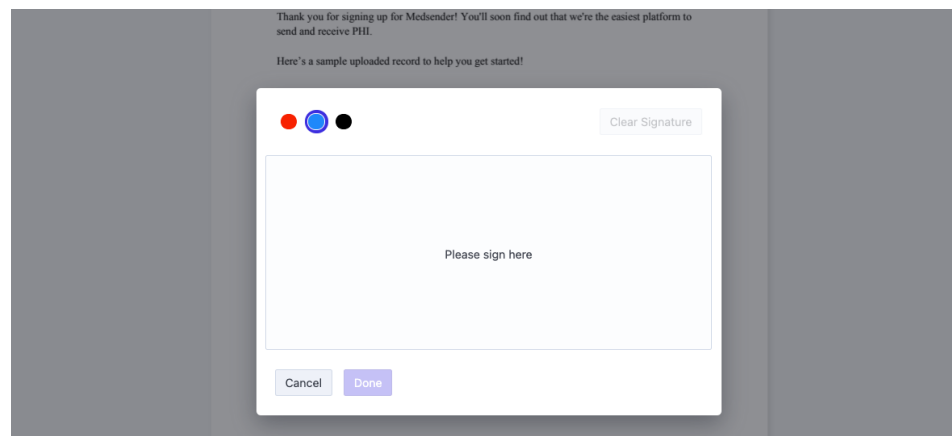
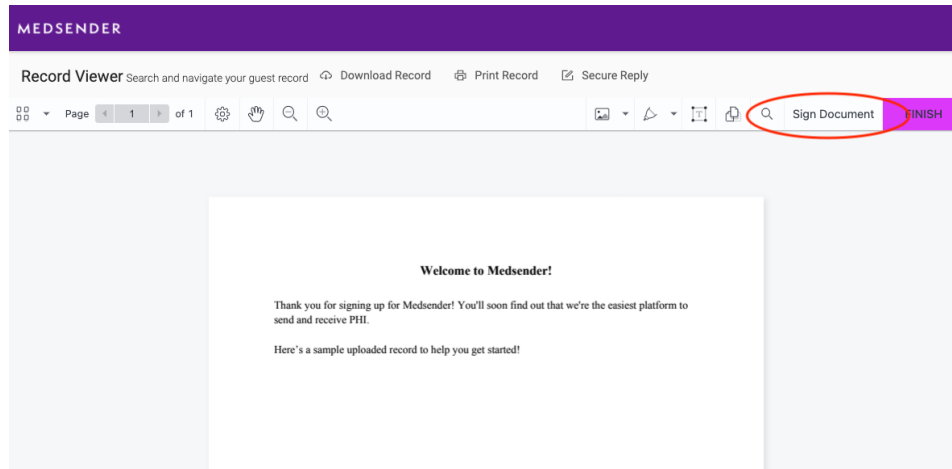

Once you sign the document, you can drag and resize your signature as needed. Please click the “Submit” button in the upper right to send your signed document back.

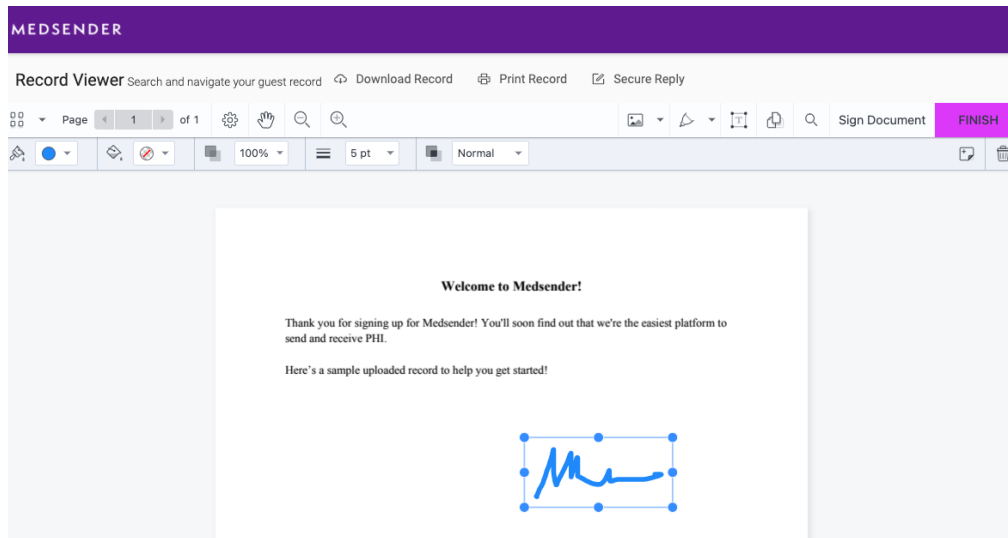

**If you need to send us documents in the future, please log into the Kareo Patient Portal and send us a message with the document attached.**

**If you need to sign up for the Kareo Patient Portal, please contact the office so that we may invite you; you will then receive the sign up information via email.**

**For urgent matters, please contact the office by phone.**